

# State of Wyoming Corner Record

(In compliance with the CORNER PERPETUATION AND FILING ACT, Wyoming Statutes, 1997 Section 33-29-140 et. seq., and the Rules and Regulations of the Board of Professional Engineers and Professional Land Surveyors)

Reverse side of this form may be used if more space is needed.

Record of original survey and citation of source of historical information (if corner is lost or obliterated). Description of corner monumentation evidence found and/or monument and accessories established to perpetuate the location of this corner. Sketch of relative location of monument, accessories, and reference points with course and distance to adjacent corner(s) (if determined in this survey). Method and rationale for reestablishment of lost or obliterated corner.

ORIGINAL CALL FOR 20" X 10" X 8" BOULDER STONE.

FOUND MOUND OF STONES AT TOP OF RIDGE. ACCEPTED MOUND AS WITNESS TO CORNER, AND SET 3/4" X 30" REBAR WITH 3 1/4" ALUMINUM CAP P.L.S. 6099 AT LOCATION OF STONES. TRUE CORNER FALLS ON STEEP SOUTH FACE OF HILL, WITH VISIBLE RECENT EROSION. SET TIES AS SHOWN BELOW.

Monument location

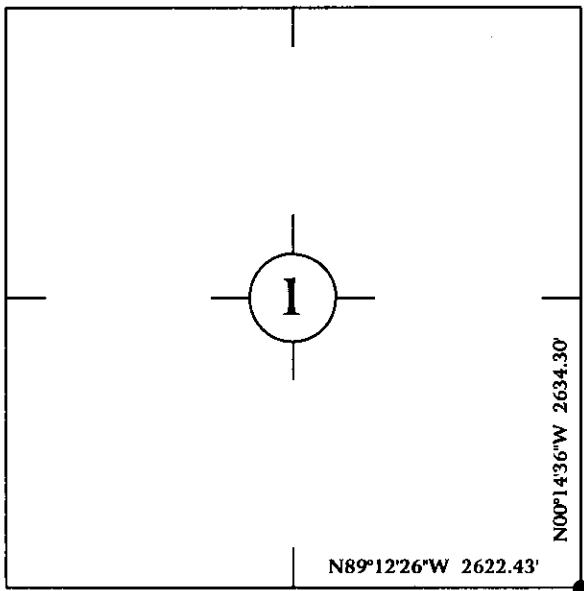

Monument Inscription

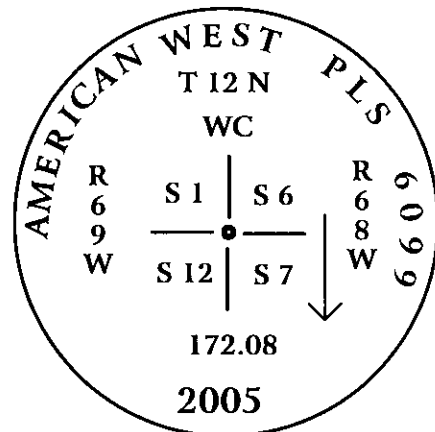

3 1/4" ALUMINUM CAP ON 3/4" X 30" REBAR.

Date of Field Work: April 26, 2005

Office Reference: GALLEGOS05.pro

## Cross Index Plat

1	2	3	4	5	6	7	8	9	10	11	12	13	14	15	16	17	18	19	20	21	22	23	24	25	
A																									A
B																									B
C	6																								C
D		5																							D
E			4																						E
F				3																					F
G					2																				G
H						1																			H
I																									I
J																									J
K																									K
L																									L
M																									M
N																									N
O																									O
P																									P
Q																									Q
R																									R
S																									S
T																									T
U																									U
V																									V
W																									W
X																									X
Y																									Y
Z																									Z

Firm/Agency, Address  
 CHARLES H. RUSSELL P.L.S. 6099  
 AMERICAN WEST LAND SURVEYING CO.  
 29 SOUTH 4TH AVENUE  
 BRIGHTON, CO 80601

This corner record was prepared by me or under my direction and supervision.  
 SEAL & SIGNATURE

Telephone Number:  
 303-659-1532



RECORDED 6/22/2005 AT 12:35 PM REC# 420216 BK# 1888 PG# 1086  
 DEBRA K. LATHROP, CLERK OF LARAMIE COUNTY, WY PAGE 1 OF 1

Corner Name: Southeast Corner of Section 1, T 12 N, R 69 W, 6th P.M.

Cross-Index No.: E-25

County: Laramie Wyoming

SBRPEPLS/PLSW: March 1994; PLSW January 1998